

Technical Bulletin

Model
6 Cyl.

Group
4

Subject:
Revised Front Wheel Hubs
and Tension Ring

Part Identifier
4057

Number
9405

ATTENTION: Service Manager / Service Technician

Models Affected: *911 Carrera 1995*

Concern: Effective immediately, revised wheel hubs (same as Carrera 4) and tension rings are being installed in production.

As of March 1, 1994 VIN:
997 SS 320633 Coupe
994 SS 340296 Cabriolet

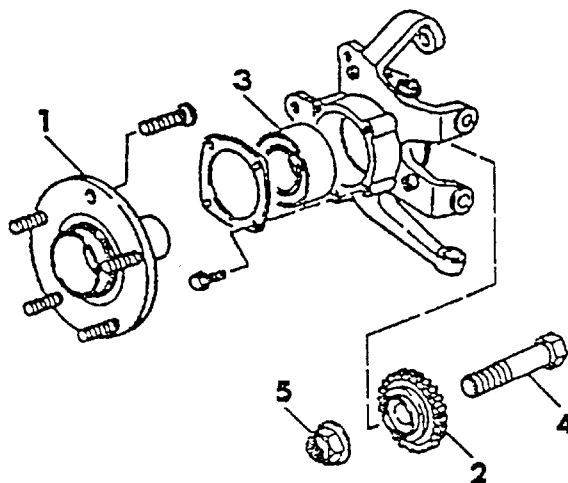

Part Identifier:	Figure	Description	Current Part Number	Previous Part Number
	1	Wheel hub	964 341 065 03*	964 341 065 12
	1	Wheel hub	964 341 065 04	
	2	Tension ring	993 341 155 01	993 341 155 00
	3	Bearing	999 053 041 02	999 053 041 02
	4	Bolt	900 082 123 09	900 082 123 09
	5	Self-locking nut	999 090 008 09	999 090 008 09

*The wheel hub 964 341 065 03 (same as Carrera 4) was installed only on the first few cars. As of March 7, 1994, a revised wheel hub with the part number 964 341 065 04 was installed in production.



Technical Bulletin

Model
6 Cyl.

Group
4

Subject: Revised Front Wheel Hubs and Tension Ring

Part Identifier
4057

Number
9405

Repairs:

The revised wheel hubs and tension rings are changed in the wheel bearing area (see Figure A, circle). The tension ring is now being centered by the wheel hub and no longer by the bearing ring.

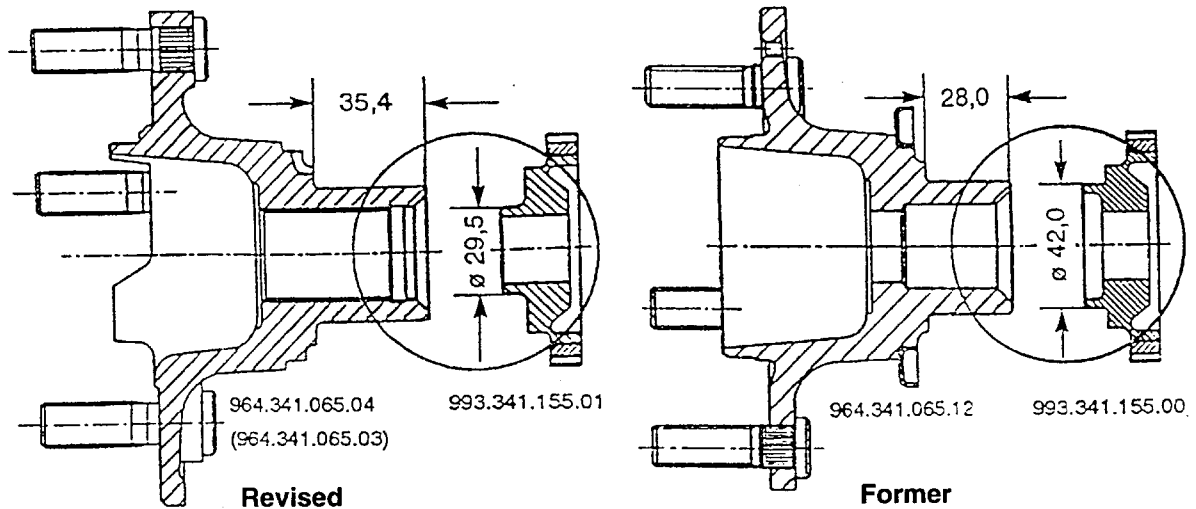

Figure A

If on cars produced before March 7, 1994 introduction date, the wheel hub or the tension ring is being replaced, the correct application of hub and tension ring must be adhered to. See chart below:

Vehicle Type	Wheel Hub	Tension Ring
911 Carrera (993)	964 341 065 03/04	993 341 155 01 (48 teeth)
911 Carrera 4 (964)	964 341 065 03/04	
911 Carrera 2 (964)	964 341 065 12	964 341 155 13 (45 teeth)
911 America Roadster		
911 Turbo (964)		
911 RS America		

NOTE: No other selection is permissible!



PORSCHE
CARS
NORTH
AMERICA
INC.

Technical Bulletin

Model
6 Cyl.

Group
4

Subject:
Revised Front Wheel Hubs
and Tension Ring

Part Identifier
4057

Number
9405

Installation:

1. When the front wheel hub is removed, the wheel bearing is damaged and must be replaced.
2. Always replace the self-locking nut.
3. Torque front wheel nut to 460Nm (311 ft.lb.). (Thread and nut contact surface **without** grease — only 993.)

P
O
R
S
C
H
E

C
A
R
S

N
O
R
T
H

A
M
E
R
I
C
A

I
N
C
.

